



# ELECTRA LAZER

## Owner's Manual



### ATTENTION: PRIOR TO FIRST USE



It is recommended that everyone who uses this product should read the StrikeMaster owner's manual.

Battery must be fully charged prior to first use. Ice depth, blade condition, loose blade bolts, battery maintenance can all affect the total number of holes you will get on a full charge.

When charging the internal 12 volt battery, using the StrikeMaster 2 amp battery charger, ALWAYS connect the charger to a standard 110 volt wall outlet before connecting to the auger.

# STRIKEMASTER®

## Ice Augers

Ice Fishing has become one of the fastest growing and most popular winter sports, allowing the ardent angler the opportunity to enjoy their favorite outdoor activity year round.

When you purchase a StrikeMaster® power ice auger, you selected a product that has gained a reputation as the quality leader since 1946. There is no doubt that this year's model is the finest ever produced by StrikeMaster®.

Your new StrikeMaster® ice auger has all of the most wanted features in a power ice auger, to assure many years of enjoyable ice fishing. Some of these features such as workmanship, engineering excellence, and dependability have long been standards at StrikeMaster®. Your new power ice auger boasts many new features while retaining the best features developed in previous years to enhance your ice fishing experience and add to your satisfaction in selecting StrikeMaster®.

We know that you are anxious to go fishing and use your new power ice auger, but before you go fishing, it is important and to your advantage to spend a few minutes getting acquainted with your new StrikeMaster power ice auger. There is no better way to acquaint yourself with the product than to read the Owner's Manual and operating instructions. A few minutes spent studying this manual before your first ice fishing outing will be time well spent.

**Record the motor serial number and date purchased in the space below.**  
**Also, please return the enclosed WARRANTY CARD or submit your information on our website to validate your limited warranty.**

Model: Electra Lazer

Serial number \_\_\_\_\_ - \_\_\_\_\_

Date Purchased \_\_\_\_/\_\_\_\_/\_\_\_\_



Serial Number label is located  
on front of auger

### ⚠ ATTENTION ⚠

**⚠ THIS SYMBOL POINTS OUT IMPORTANT SAFETY INSTRUCTIONS WHICH IF NOT FOLLOWED COULD ENDANGER THE PERSONAL SAFETY AND/OR PROPERTY OF YOURSELF AND OTHERS. READ AND FOLLOW ALL INSTRUCTIONS IN THIS MANUAL AND ANY PROVIDED WITH OR ON THE EQUIPMENT ON WHICH THIS ENGINE IS USED BEFORE ATTEMPTING TO OPERATE YOUR STRIKEMASTER POWER ICE AUGER.**

### TABLE OF CONTENTS

Important Safeguards.....	3
Operation Instructions.....	3
Assembly Instructions.....	3
Replacement Battery Installation.....	4
Battery Charging & Monitoring.....	4
Battery Storage .....	4
STRIKEMASTER Limited Warranty .....	Back Cover

## ⚠ IMPORTANT SAFEGUARDS ⚠

It is recommended that everyone who uses this product should read this StrikeMaster OWNER'S MANUAL before operating.

1. **DO NOT** use this product for other than its intended purpose.
2. **DO NOT** use attachments other than those available from the manufacturer.
3. **DO NOT** alter this product in any manner; doing so is dangerous and voids all warranties.
4. **DO NOT** allow children or adults weighing under 100 lbs. to operate this equipment.
5. **DO NOT** allow your body, loose clothing, drawstrings, scarves, hats or other materials to come in contact with the Powerhead, or Auger (Drill) unit at any time.
6. **DO NOT** operate under the influence of drugs or alcohol.
7. **DO NOT** continue to use this product in the event of mechanical or electrical failure.
8. This product produces considerable cutting force that is felt by the operator. Make sure your feet are firmly planted and that the handles are held firmly while operating this product.
9. During operation, the auger unit could possibly stop. Be prepared at all times to release the switch.
10. Check cutting blades and auger shaft screws before and after each use to make sure they are tight.

## ⚠ ASSEMBLY ⚠

- 1** Carefully remove blade guard and make sure blade bolts are tight.

(8mm bolts and 8mm closed end wrench)



- 2** Remove metric allen wrench taped to the neck of auger and unscrew the collar bolt from auger.

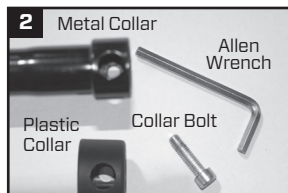

- 2a** The large and small holes from each component must line up before installing the collar bolt.

Push down and twist to line up holes.



- 3** Insert auger into drive shaft and install collar bolt.



- 3a** Collar bolt inserts into the large hole, passes through the drive shaft and threads into the small hole of the metal collar. Make sure bolt is tight. Some wiggle is normal between the power head and auger. Check and tighten often.



- 4** After assembly is complete, you can conveniently store your allen wrench on the underside of the throttle pedal.



- 5** ⚠ It is recommended that the collar bolt be checked and torqued firmly before and after every use.

## ⚠ OPERATION ⚠

- 1** The Electra Lazer can be operated using the Internal 12 volt battery or connected to an External 12 volt power source.

To use the Internal battery source, move the battery switch from the OFF position to the internal position. To operate, push the black starter button.

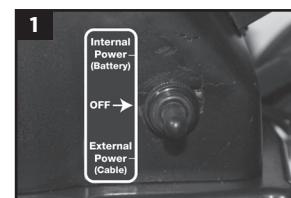

- 2** To use an external battery source, connect the external battery cable using the wiring harness. After the wiring harness is connected to the Electra Lazer unit the clips can be connected to the battery source. Red clamp to positive [+] battery post, black clamp to negative [-] battery post. To operate, move the battery switch from the OFF position to the external position. To operate push the black starter button.

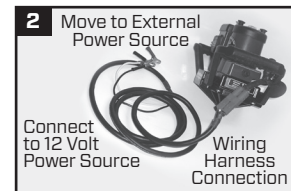

- 3** Make sure your footing is secure and you have the unit in the vertical position, and firmly in your hands. Press the Black Starter button down to start the auger rotation. **TO STOP** - Release the black starter button. ALWAYS place the battery selection switch to the OFF position when the Electra Lazer is not in operation.

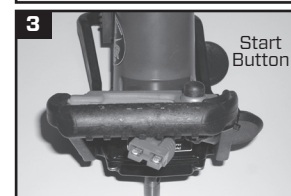

## ⚠️ REPLACEMENT BATTERY INSTALLATION ⚠️

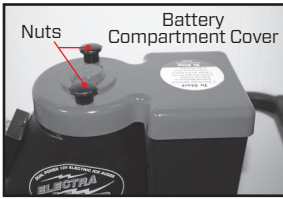

- 1 Remove nuts by rotating counter-clockwise from top of battery compartment and lift battery compartment cover off.

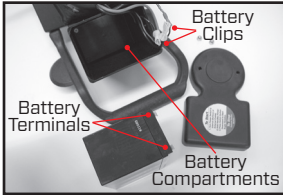

- 2 Slide battery into battery compartment,

**NOTE: Be sure to hold the wires in the battery compartment so they do not slide down inside compartment under the battery.**

- 3 Connect the battery clips to the battery.

**NOTE: Make sure you hook the positive [+] battery clip (red wire) to the positive [+] terminal on the battery, and the negative [-] battery clip (black wire) to the negative [-] battery terminal.**

- 4 Slide battery all the way inside battery compartment while tucking the wires inside the compartment beside battery.

- 5 Replace battery compartment cover and tighten top nuts clockwise.

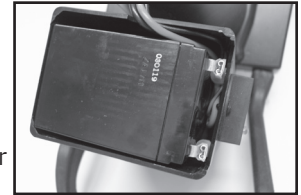
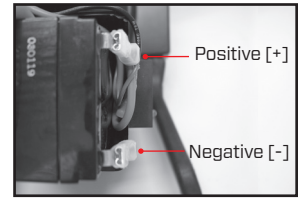

## ⚠️ BATTERY CHARGING & MONITORING ⚠️

### CHARGING WITH WALL CHARGER ADAPTER

When charging the internal 12 volt battery, using the StrikeMaster 2 amp battery charger, **ALWAYS** connect the charger to a standard 110 volt wall outlet before connecting to auger. Make sure the switch is in the OFF position. **DO NOT rely on meter indicator, use battery charger to automatically stop charging when battery is full. After battery is fully charged, the charger changes to maintenance/float mode. DO NOT leave the charger connected to the battery for more than 24 hours.**

1. Always charge the battery at room temperature. If the battery is used in a cold environment, allow it to warm up for at least an hour before charging. Cold batteries will not charge completely.
2. To charge the battery, **ALWAYS** connect the charger to a standard 110 volt wall outlet before connecting to auger (red light should come on). Plug charger into auger charging plug. During charging phase light will be yellow. Charge the battery until the light on the charger turns green.
3. To disconnect charger remove plug from wall outlet, then disconnect charger from auger.
4. Charge times can range up to 24 hours for completely dead battery. Average 4-10 hrs. charge time. **DO NOT leave the charger connected to the battery for more than 24 hours.**



5. The Battery Status Indicator is mounted on the side of the Electra Lazer to allow you to see the level of battery power while in use. To check the charge level, simply move the battery switch from the OFF position to the Internal battery position. The Power On light indicates that the battery is connected properly. The other lights on the status indicator show the charge level of the Internal battery.

**NOTE: While drilling, the battery indicator will drop considerably. To receive an accurate charge level, wait 90 seconds after drilling to read charge level.**

### CHARGING WITH VEHICLE ADAPTER

1. Insert the Vehicle Adapter into the outlet socket (located on the dashboard of most vehicles). The adapter is equipped with a red light to indicate the unit is turned on. Then plug the auger charging plug into the Electra Power Head.
2. Start your vehicle engine. The alternator in the vehicle will supply the electricity to the vehicle adapter so you don't drain the vehicle battery. It is possible to charge the battery without starting the vehicle but your vehicle battery and the discharged battery voltage will become equal. (ex. Vehicle Battery=12Vdc, Discharged Battery=1-Vdc, the result on both batteries would be around 11Vdc). It is best to always charge with the engine running.
3. Charging time depends on how low the battery is. The charging time can range from 4 to 10 hours. (Do not charge over 24 hours). During the charging process the red light will stay on. You will have to check the battery charge level indicator in order to see the level that the battery has been charged to.
4. When charging is finished: Remove the Vehicle Adapter from the automotive outlet socket. Remove the charging plug from the Electra Powerhead.
5. Store the vehicle adapter in a safe, dry place.



## BATTERY STORAGE



Connect the charger to the battery every month or two to insure that it maintains a full charge during an extended storage period. **NOTE: ALWAYS TURN THE BATTERY SELECTION SWITCH TO OFF, FAILURE TO DO SO COULD DRAIN BATTERY.**





## LIMITED WARRANTY

The warrantor's obligation shall be limited to repairing or replacing any part, which upon examination by StrikeMaster, is determined to be defective. This obligation begins on the date of purchase (as evidenced by a product receipt) and continues for a period of ONE YEAR after purchase ("warranty period"), with the exception of engines and parts subject to wear and tear. Customer is responsible for shipping and transportation charges to the nearest warranty repair center.

Company warrants that Product, other than engines and parts subject to wear and tear, will perform substantially in accordance with the accompanying written materials [owner's manual] for a period of ONE YEAR. In the case of Honda and Solo engines, the warranty period continues for a period of TWO YEARS after purchase. Parts subject to normal wear and tear are not covered by warranty including: air filter, fuel filter, any rubber part that comes in contact with fuel, clutch, spark plug, starter (recoil), and blades. In the event applicable law imposes any implied warranties, the implied warranty period is limited to ONE YEAR from the date reflected on the product receipt. Some jurisdictions do not allow such limitations on the duration of an implied warranty, so the above limitation may not apply.

TO THE MAXIMUM EXTENT PERMITTED BY APPLICABLE LAW, THE COMPANY AND AUTHORIZED SERVICE CENTERS DISCLAIM ALL OTHER WARRANTIES, EITHER EXPRESS OR IMPLIED, INCLUDING, BUT NOT LIMITED TO IMPLIED WARRANTIES OF MERCHANTABILITY AND FITNESS FOR A PARTICULAR PURPOSE WITH REGARD TO THE PRODUCT AND WRITTEN MATERIALS [OWNER'S MANUAL]. THIS LIMITED WARRANTY GIVES CUSTOMER SPECIFIC LEGAL RIGHTS. CUSTOMER MAY HAVE OTHER RIGHTS DEPENDING ON THE JURISDICTION.

TO THE MAXIMUM EXTENT PERMITTED BY APPLICABLE LAW, IN NO EVENT SHALL THE COMPANY OR AUTHORIZED SERVICE CENTER BE LIABLE FOR ANY DAMAGES WHATSOEVER (INCLUDING WITHOUT LIMITATION, SPECIAL, INCIDENTAL, OR CONSEQUENTIAL OR INDIRECT DAMAGES FOR PERSONAL INJURY, LOSS OF BUSINESS PROFITS, BUSINESS INTERRUPTION, LOSS OF BUSINESS INFORMATION OR ANY OTHER PECUNIARY LOSS) ARISING OUT OF THE USE OF OR INABILITY TO USE THIS PRODUCT, EVEN IF THE COMPANY HAS BEEN ADVISED OF THE POSSIBILITY OF SUCH DAMAGES. IN ANY CASE, THE COMPANY'S AND AUTHORIZED REPAIR CENTER'S ENTIRE LIABILITY UNDER ANY PROVISION OF THIS AGREEMENT SHALL BE LIMITED TO THE AMOUNT ACTUALLY PAID BY YOU FOR THE PRODUCT. BECAUSE SOME JURISDICTIONS DO NOT ALLOW THE EXCLUSION OR LIMITATION OF LIABILITY FOR CONSEQUENTIAL OR INCIDENTAL DAMAGES, THE ABOVE LIMITATION MAY NOT APPLY TO YOU.

Continued satisfying performance from your StrikeMaster power ice auger may be assured by applying a minimum amount of preventive maintenance.

### WARRANTY SERVICE

Visit our website for up to date warranty service and non warranty repair service centers.

[www.strikemaster.com](http://www.strikemaster.com)